



**Arts Connection is proud to collaborate with South Washington County School District #833 and the City of Woodbury to add a Center for the Arts to our Community.**

★ **GROWING COMMUNITY:** South Washington County is a fast-growing community of nearly 100,000 residents in Cottage Grove, Newport, St. Paul Park and Woodbury, and boasts many wonderful park, recreation and athletic resources. However, this vibrant community is measurably lacking in visual and performing arts spaces and opportunities for both artists & audience members.

★ **FINE ARTS DEMAND:** The availability of visual arts and performance venues in our community is limited. However, the demand for art, music, and theater is seen by the large turn-out for current local performance opportunities, as well as the long waiting lists for art & theater classes. The limitation is not lack of interest, rather lack of space. Use of area schools and churches is no longer a viable option, as those organizations have themselves grown dramatically and use their spaces nearly fulltime.

**What is needed in the South Washington County area is a home for the arts – a place that can serve as the “nerve center” for non-profit arts groups to use** for rehearsals and performances, for arts outreach and education, and for volunteer and community-building within the arts that will help to better organize and expand the fine arts experience for our growing community.

★ **A VALUE-ADDED OPPORTUNITY:** A unique opportunity to meet the need for and interest in a Center for the Arts in our community has presented itself with the passing of a bond referendum for a 3<sup>rd</sup> high school in our district. This new high school will reside on 80 acres of a 320-acre campus, with 240 acres owned by the City of Woodbury that is being co-planned to provide a new and exciting destination in our community, complete with the high school and a rich array of athletic resources and small business opportunities. This prime location can also serve as our new home for the arts to benefit artists, art students & audiences alike.

# Current Center for the Arts Design Elements

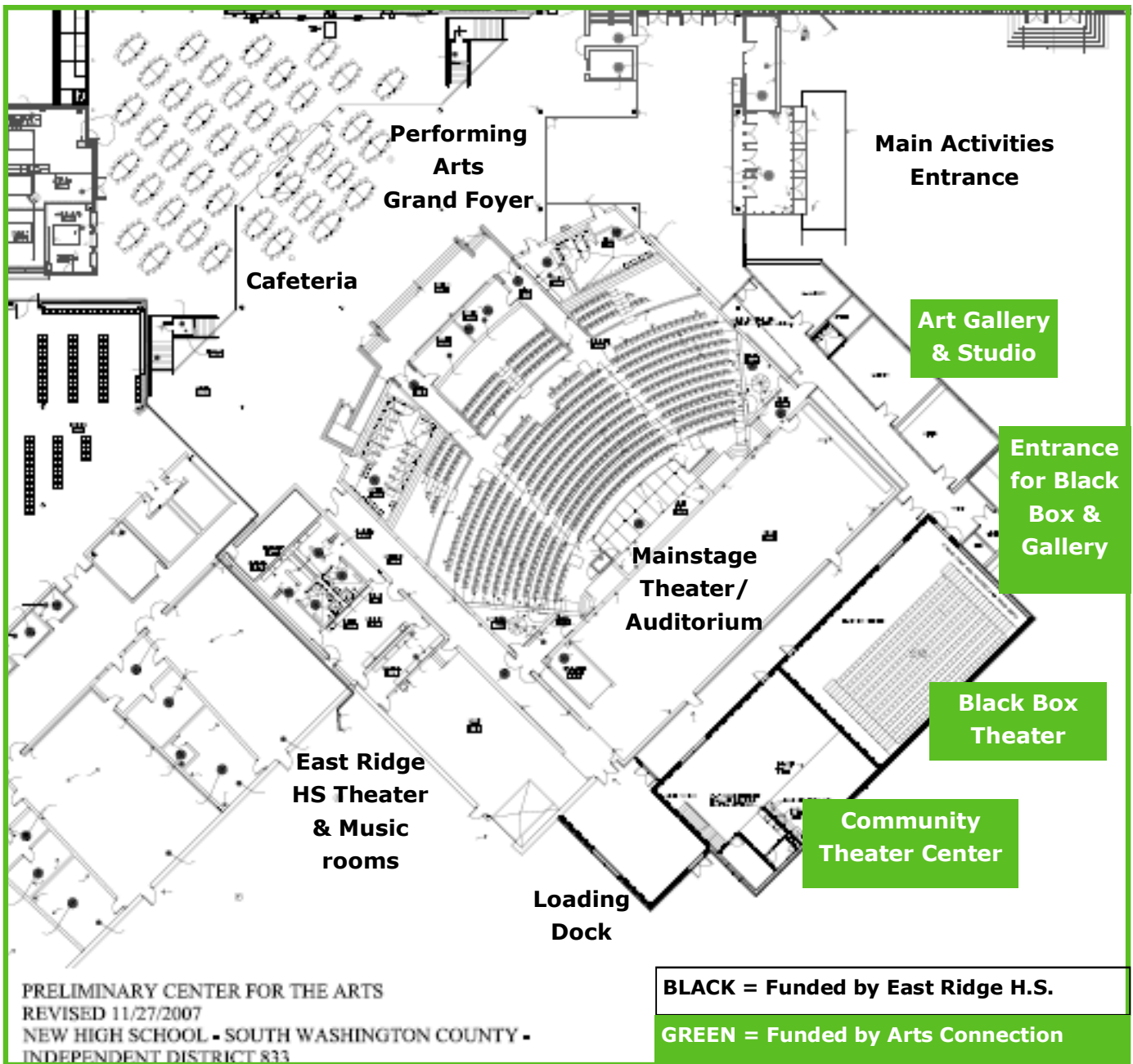

- **Art Gallery & Studio** for community arts education and display venues.
- **Black Box Theater** for rehearsals and small performances, with 200+ retractable seats.
- **Community Theater Center** for costume and set building and storage, volunteer meeting space, and a history gallery for community theater.
- **Mainstage Theater & Auditorium** featuring 948 seats with 1st and 2nd floor entrances in a state-of-the-art space for theater, orchestra, band, choir and dance performances; Arts Connection will have a cooperative use agreement with East Ridge High School to use this space for dedicated times during the year.
- **Performing Arts Grand Foyer** features a grand entrance into the main theater and auditorium, complete with a reception area for large events.
- An additional classroom or restrooms may also be added as the design is completed.

## Act One—Complete!

Many dedicated volunteers have been working hard over the past year to build a solid foundation for an art center in our community, with the following results:

- **PRIME LAND LOCATION:** Received land and leadership commitment from South Washington County District #833 for a community Center for the Arts.
- **ARCHITECTURAL DESIGN:** Received architectural design support for the arts center.
- **ARTS CONNECTION OFFICE:** Received in-kind support from the City of Woodbury for an Arts Connection office.
- **ENDOWMENT PLEDGE OF \$1.6 MILLION:** Secured anonymous pledge currently valued at \$1.6 million to act as an operating fund and endowment for the art center.
- **LEADERSHIP TEAM & STAFF ESTABLISHED:** Established a leadership team and hired a consultant to assist with fundraising and further development of the Center for the Arts.

## Act Two—We Need You!

**Our goal for Act Two: Raise \$2 Million to build the new Center for the Arts!**

**SO PLEASE, TAKE YOUR SEAT!**



**Please consider naming a seat in the new theater!** All gifts of \$1,500 or more can be given as a 3-year pledge. Please consider a bold pledge before March 1, 2008! If we secure financing before March 1, we can then build the center along with the high school, saving on construction costs. Each \$1,500 gift will receive a named seat plaque on a mainstage theater seat, or one leaf on the art gallery giving tree. Gifts of \$3,000 and more will also receive permanent recognition on our Founders Plaque in the Center for the Arts.

★ **SPONSOR a theater seat:** \$500 a year x 3 years = \$1,500 total pledge  
- One named seat plaque (or art gallery giving tree leaf)

★ **PARTNER with us:** \$1,000 a year x 3 years = \$3,000 total pledge  
- Two named seat plaques + 1 name on Founders Plaque

★ **Be an ARTS BUILDER:** \$2,500 a year x 3 years = \$7,500 total pledge  
- Five named seat plaques + 1 name on Founders Plaque

### OTHER NAMING OPPORTUNITIES

- ★ **Center for the Arts:** \$400,000
- ★ **Black Box Theater:** \$250,000
- ★ **Community Theater Center:** \$250,000
- ★ **Art Gallery:** \$100,000
- ★ **Art Studio:** \$50,000

**- OR -**

\$500 a year from you + \$2,000 a year from 4 others  
- Build support for the arts by sponsoring one seat for yourself, and then helping to secure 4 additional seat sponsors and be named an Arts Builder!  
- 1 named seat plaque + **Your name** on Founders Plaque

**Arts Connection is a 501 (c)(3) non-profit organization and all gifts to the Center for the Arts are tax-deductible.**

**Art is the signature of civilizations. Beverly Sills, Opera Singer**



8301 Valley Creek Road

Woodbury, MN 55125

651-714-3571

info@myartsconnection.org

## CENTER FOR THE ARTS Capital Building Pledge Form

*All gifts to Arts Connection are tax-deductible to the fullest extent of the law. Please fill out and return this pledge or donation form to Arts Connection at the address listed here.*

Name (s) \_\_\_\_\_

Business Name (if applicable) \_\_\_\_\_

Address \_\_\_\_\_

City \_\_\_\_\_ State \_\_\_\_\_ Zip \_\_\_\_\_

Phone # \_\_\_\_\_ Email \_\_\_\_\_

**YES, I WILL "TAKE MY SEAT" IN THE CENTER FOR THE ARTS!**  
(Please see backside of this form for a detailed description of giving levels. We will contact you closer to project completion to confirm how you would like the wording to appear on your donor recognition items.)

### STEP 1: SELECT YOUR GIVING LEVEL

- |  |  |
|--|--|
| <input type="checkbox"/> <b>SPONSOR:</b> \$1,500 (\$500 x 3 yrs.)        | <input type="checkbox"/> <b>PARTNER:</b> \$3,000 (\$1,000 x 3yrs.) |
| <input type="checkbox"/> <b>ARTS BUILDER:</b> \$7,500 (\$2,500 x 3 yrs.) | <input type="checkbox"/> <b>OTHER AMOUNT:</b> \$ _____             |
- OR-**
- ARTS BUILDER:** \$1,500 (\$500 x 3 YEARS FOR YOU + 4 ADDL. SEAT SPONSORS; ATTACH ADDL. PLEDGE FORMS)

**ALL GIFTS MATTER! ANY GIFT OF \$25+ WILL BE RECOGNIZED IN ANNUAL REPORT**

### STEP 2: IDENTIFY HOW YOU WILL MAKE YOUR GIFT

- All at once:**  See check attached (payable to Arts Connection)
- Based on the following pledge schedule:** Total of \$ \_\_\_\_\_ to be paid in # \_\_\_\_\_ installments of \$ \_\_\_\_\_ each beginning (date) \_\_\_\_\_

**Pledge Signature:** \_\_\_\_\_

- First pledge payment is attached. Today's date is** \_\_\_\_\_  
(Selection of specific theater seats is "first come, first served" as the first year of the pledge is paid. We'll contact you to select your specific seat to be named.)
- Through a gift of stock or securities.** Please contact me for more information.

### STEP 3: SELECT OTHER OPTIONS, IF APPLICABLE, AND THEN SEND FORM + PAYMENT TO ARTS CONNECTION AT ADDRESS LISTED AT TOP OF FORM

- My employer will match my gift.** Please contact me to get the paperwork.
- I plan to make this gift in memory or honor of someone.** Please contact me for naming information.

*Financial support may be publicly recognized in an annual listing of donors.  
 Check this box if you wish to remain anonymous.*

**For more information or questions, call Michelle Witte @ 651-402-3184**

*We are all angels with only one wing; only when we come together can we fly. Luciano de Crescenzo, Author*

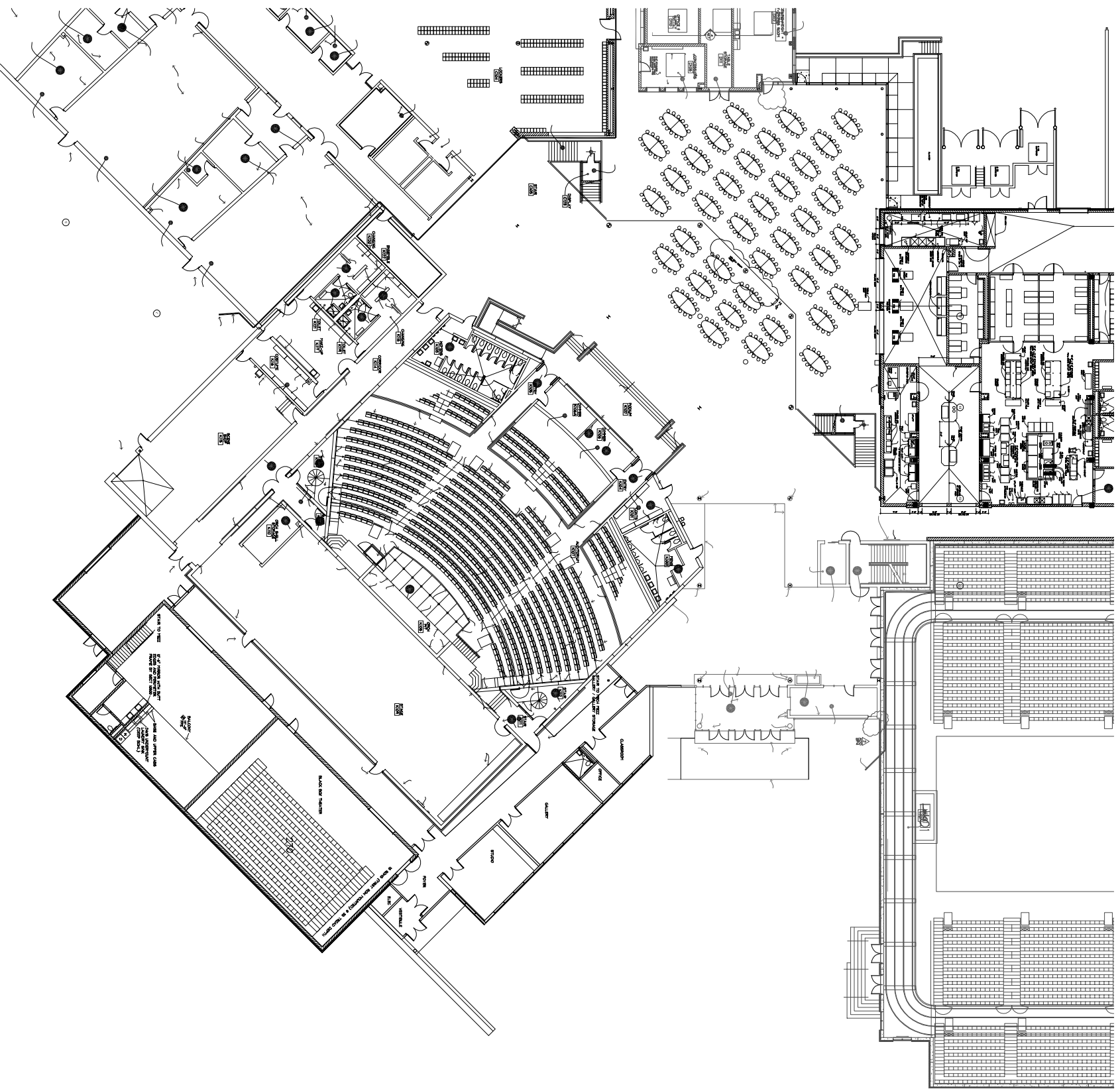

PRELIMINARY CENTER FOR THE ARTS  
REVISED 11/27/2007  
NEW HIGH SCHOOL - SOUTH WASHINGTON COUNTY -  
INDEPENDENT DISTRICT 833

ARCHITECTS REGO + YOUNGQUIST inc.



7601 WANZATA BOULEVARD, ST. LOUIS PARK, MINNESOTA 55426 (952) 544-8941

